

ALE 080122

Production Proven 24/7
Beam Bender
2" Clear Aperture

Key Features

- 2" (25.4 mm) clear aperture
- Designed for high power application (up to 12 kW)
- Orthogonal steering $\pm 2^\circ$ with precision adjustment screws
- Direct mirror cooling
- Non-defeatable safety interlock
- Input, output, and side mounting (metric or imperial)
- Weight: ~ 7.3 lb (3.3kg)

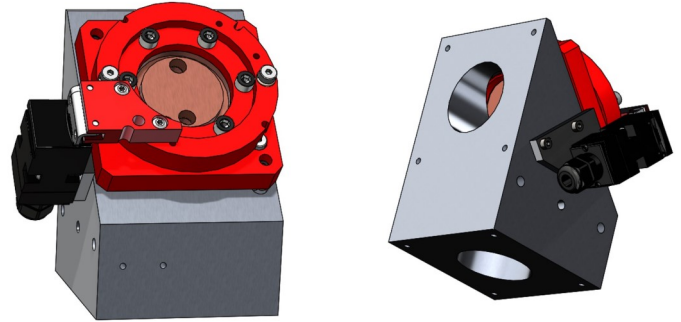

Specifications

